







Room 7.1 A, B, C

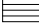

253 sqm (81 + 91 + 81sqm)
Room height: 4.47 m

Soundproof doors and walls
The room can be divided with airwalls

-  Emergency exit
-  Fire extinguisher
-  Built-in floor box
-  4 X wall sockets
-  Power socket
-  Air conditioning unit
-  Ventilation grill

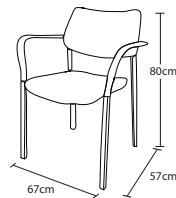

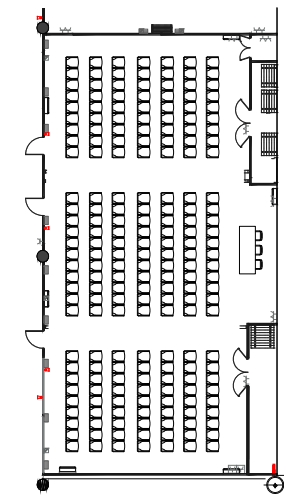
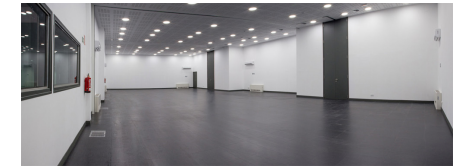
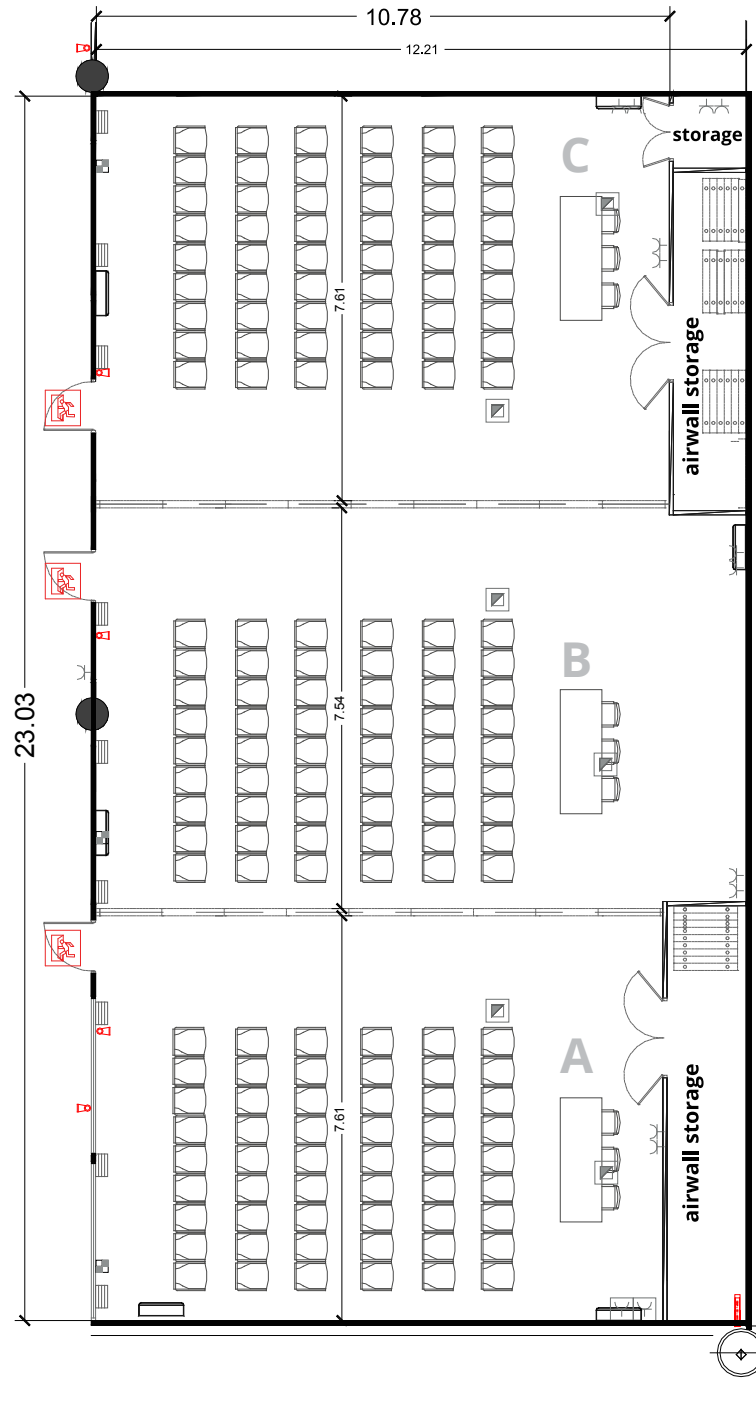

There are two soundproof windows in this room
Dimensions: 1.92m X 0.88m each



Option with no partitions

ROOM CAPACITIES

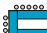
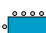
				
	Theatre	Classroom*	U shape*	Boardroom*
7.1	203	104	54	56
A	54	24	20	24
B	54	30	20	24
C	54	24	20	24

* using 160 X 80cm tables for 2 pax each