

# Conference Center 7

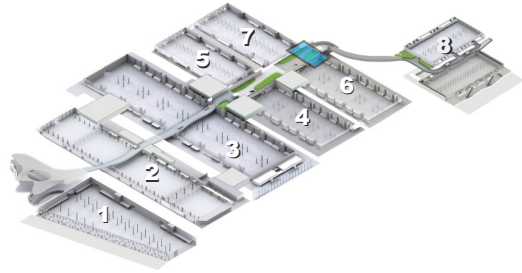

Room	sqm	pax	default format	height
7.1	253	203	theatre	4,47m
A, B or C	81/91/81	54		
7.2	37	16	boardroom	3 m
7.3	37	16		
7.4	40	16		
7.5	40	16		
7.6	13	8		
7.7	13	8		
7.8	26	16		
7.9	26	16		
7.10	21	14		
7.11	38	16		
7.12	24	14		
7.13	24	14		
7.14	38	16		
7.15	35	16		



# Room 7.1 A, B, C



253 sqm (81 + 91 + 81sqm)  
Room height: 4.47 m

Soundproof doors and walls  
The room can be divided with airwalls

- Emergency exit
- Fire extinguisher
- Built-in floor box
- 4 X wall sockets
- Power socket
- Air conditioning unit
- Ventilation grill

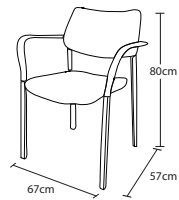

There are two soundproof windows in this room  
Dimensions: 1.92m X 0.88m each

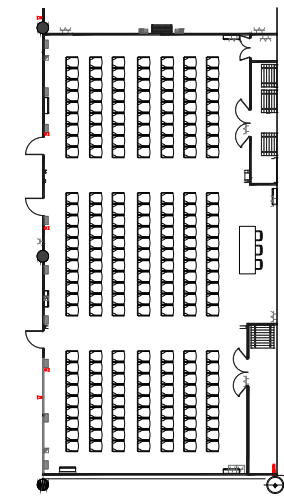
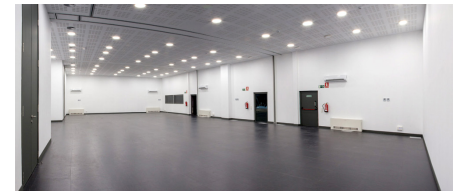
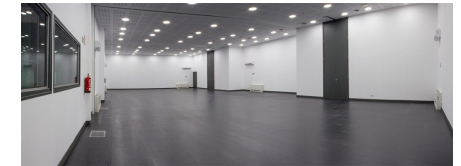
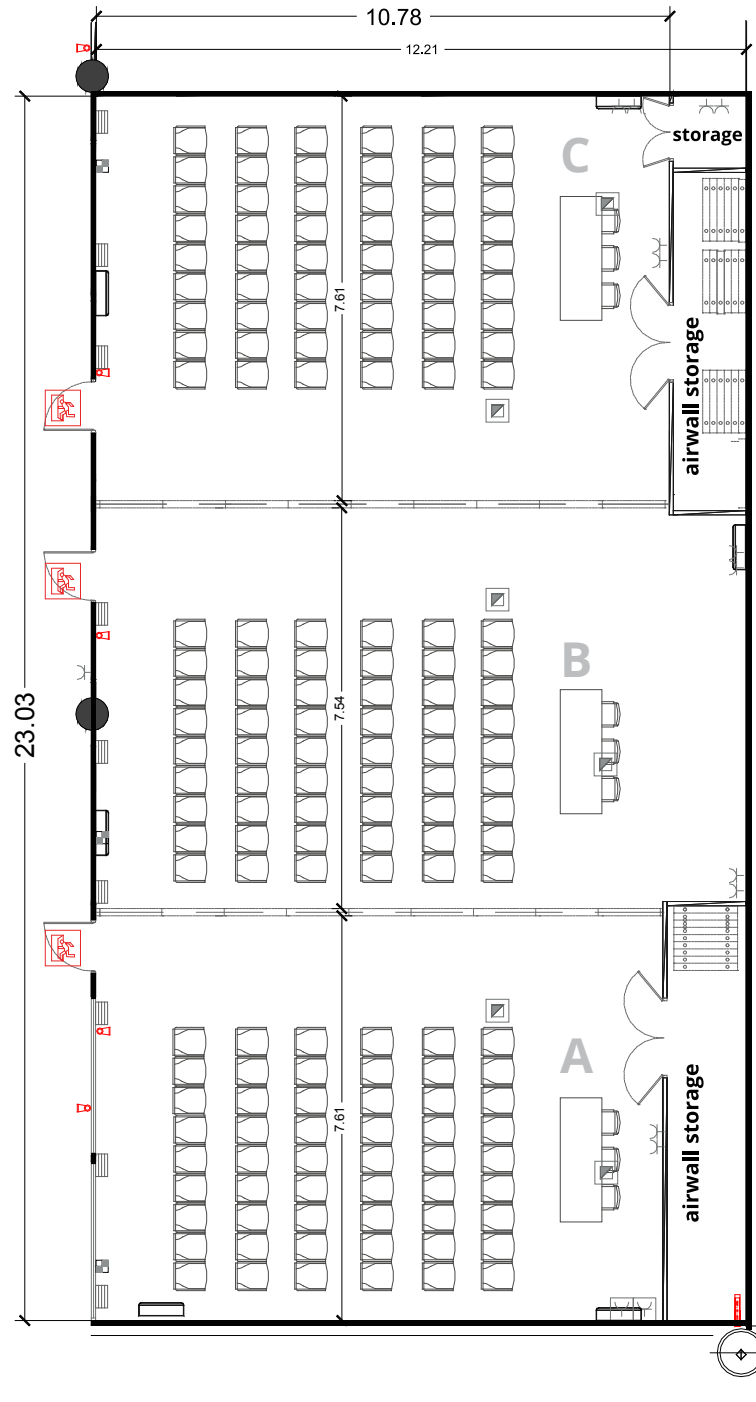
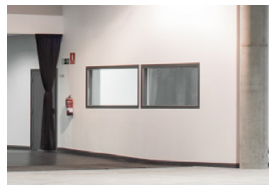

Option with no partitions

### ROOM CAPACITIES



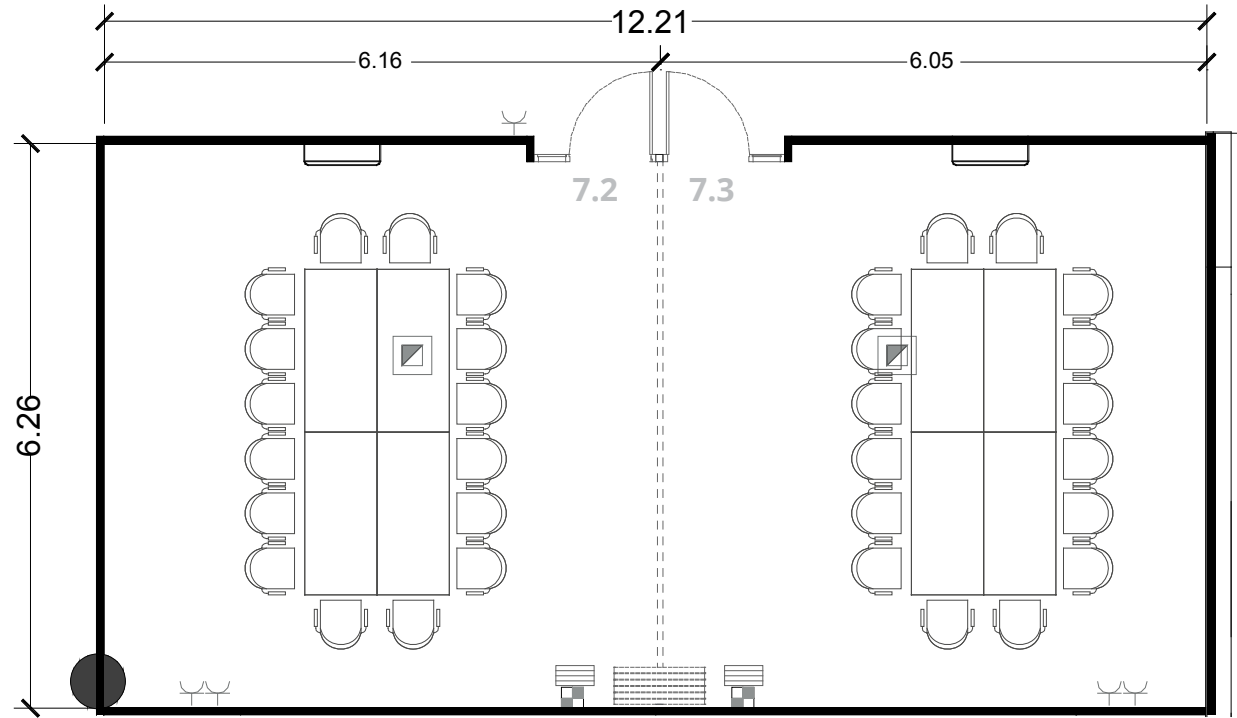
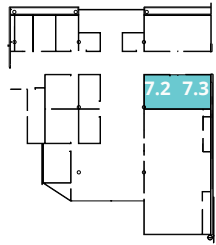

	Theatre	Classroom*	U shape*	Boardroom*
<b>7.1</b>	203	104	54	56
<b>A</b>	54	24	20	24
<b>B</b>	54	30	20	24
<b>C</b>	54	24	20	24

\* using 160 X 80cm tables for 2 pax each

# Rooms 7.2 and 7.3

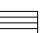

74 sqm (37+ 37sqm)  
Room height: 3.00 m

-  Built-in floor box
-  4 X wall sockets
-  Power socket
-  Air conditioning unit
-  Ventilation grill

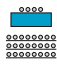
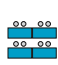
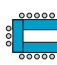
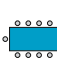
ROOM CAPACITIES				
				
	Theatre	Classroom	U shape	Boardroom
7.2 or 7.3	32	16	12	16
7.2 + 7.3	64	32	22	24

The default format is boardroom

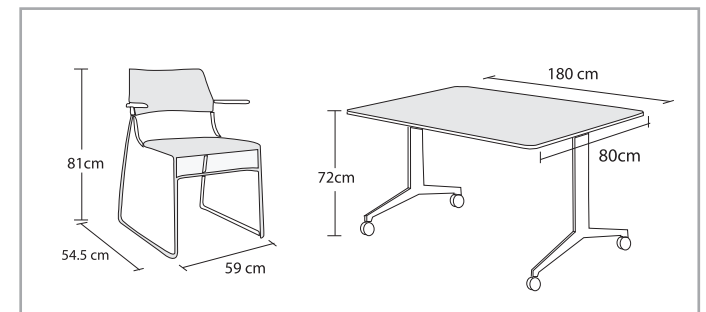

# Rooms 7.4 and 7.5









80 sqm (40 + 40sqm)

Room height: 3.00 m

Soundproof doors and walls

The room can be divided with airwalls

-  Emergency exit
-  Built-in floor box
-  4 X wall sockets
-  Power socket
-  Air conditioning unit
-  Ventilation grill

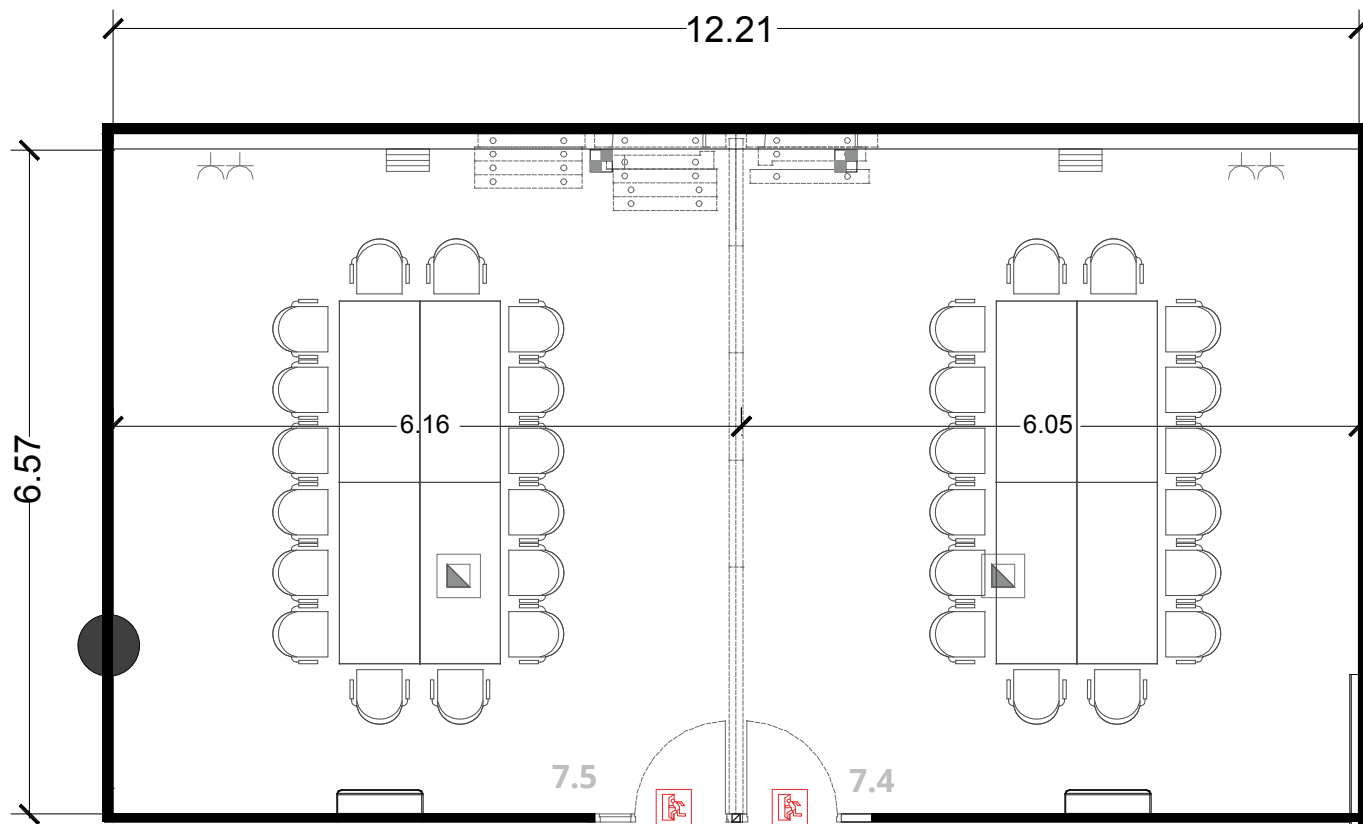

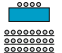
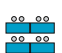
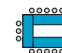
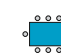
ROOM CAPACITIES				
				
	Theatre	Classroom	U shape	Boardroom
7.4 or 7.5	32	16	12	16
7.4 + 7.5	64	32	22	24

The default format is boardroom

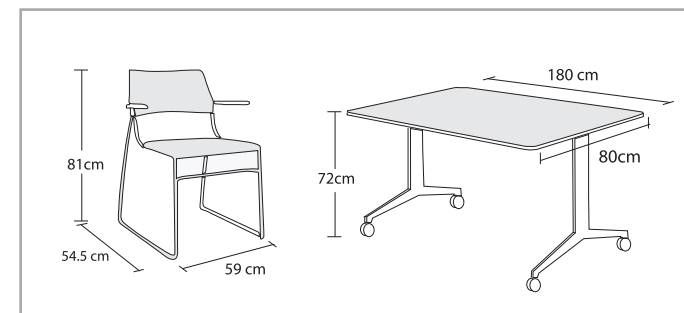



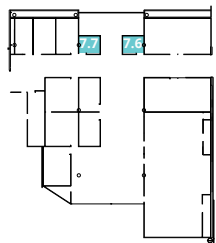

# Rooms 7.6 and 7.7

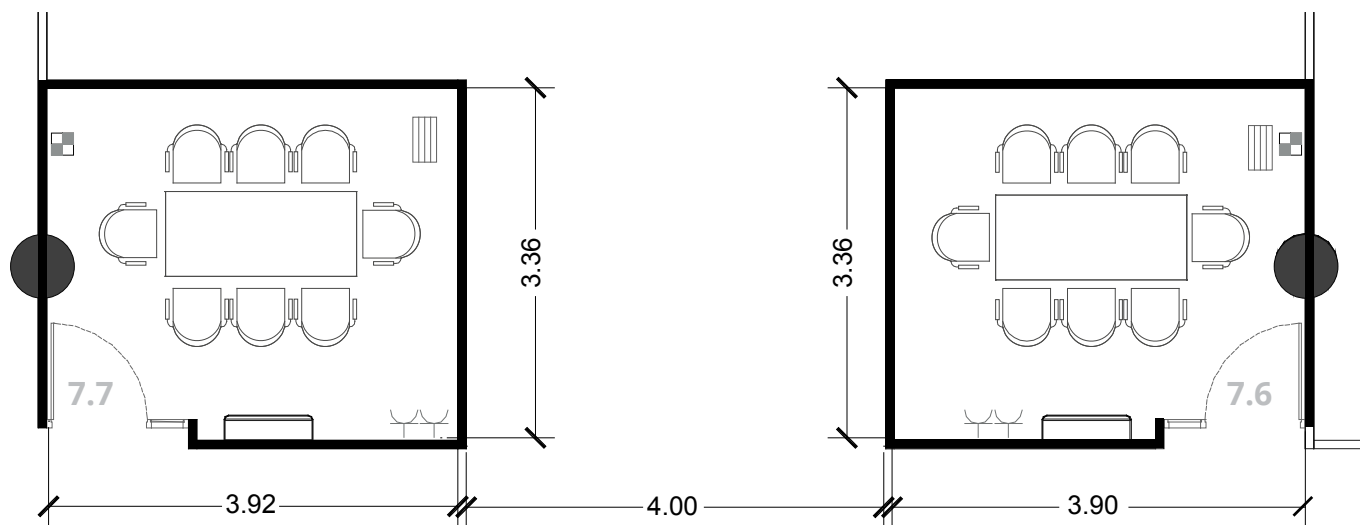

13 sqm each  
Room height: 3.00 m

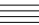

-  Built-in floor box
-  4 X wall sockets
-  Power socket
-  Air conditioning unit
-  Ventilation grill



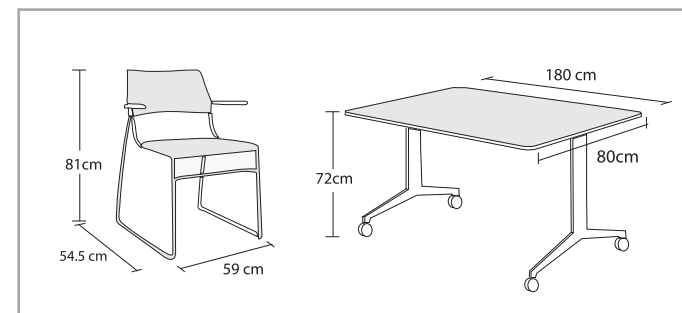

Room capacity: 8 pax each

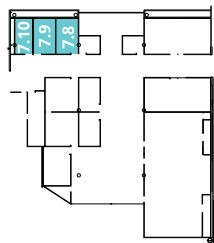

# Rooms 7.8, 7.9 and 7.10

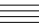

26 sqm/ 26sqm and 21sqm  
 Room height: 3.00 m  
 Capacity: 16 pax/ 16 pax / 14 pax

-  Built-in floor box
-  4 X wall sockets
-  Power socket
-  Air conditioning unit
-  Ventilation grill

Room capacity: 16 / 16 / 14 pax

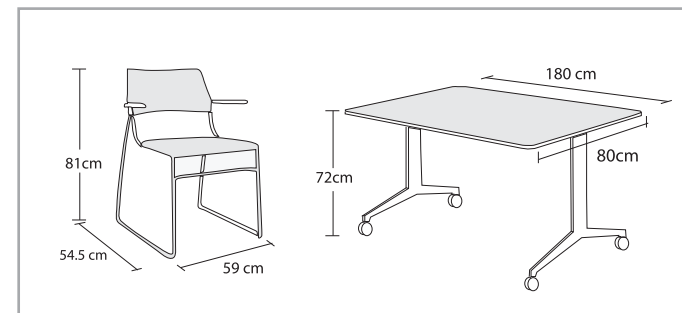
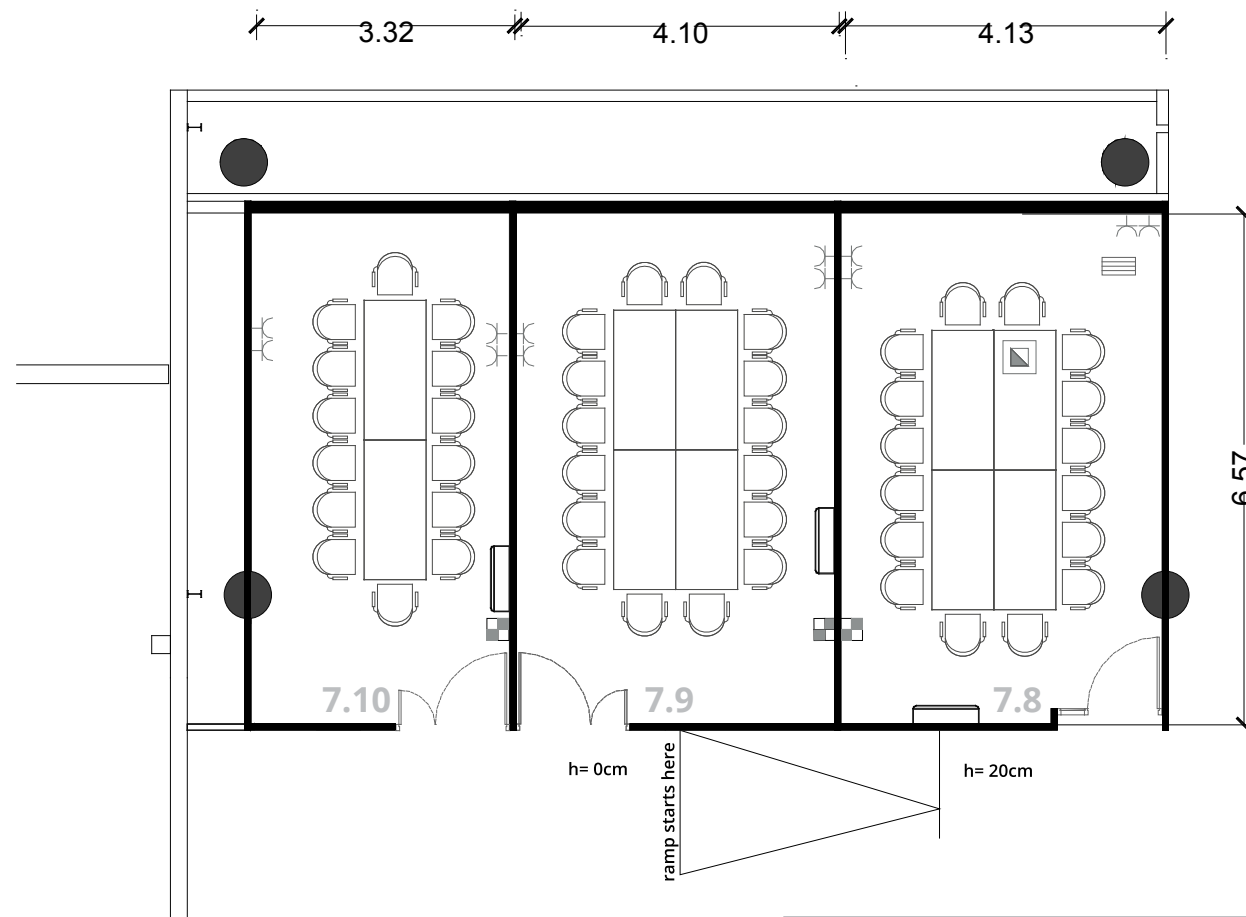



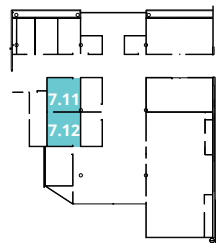

# Room 7.11 and 7.14



38 sqm each

Room height: 3.00 m

Both rooms are connected through a lockable door

-  Built-in floor box
-  4 X wall sockets
-  Power socket
-  Air conditioning unit
-  Ventilation grill

Room capacity: 16 pax each

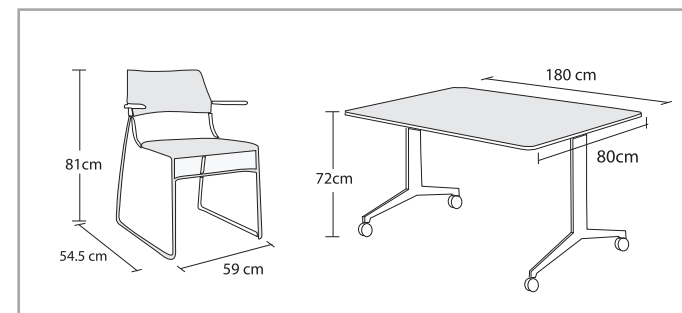
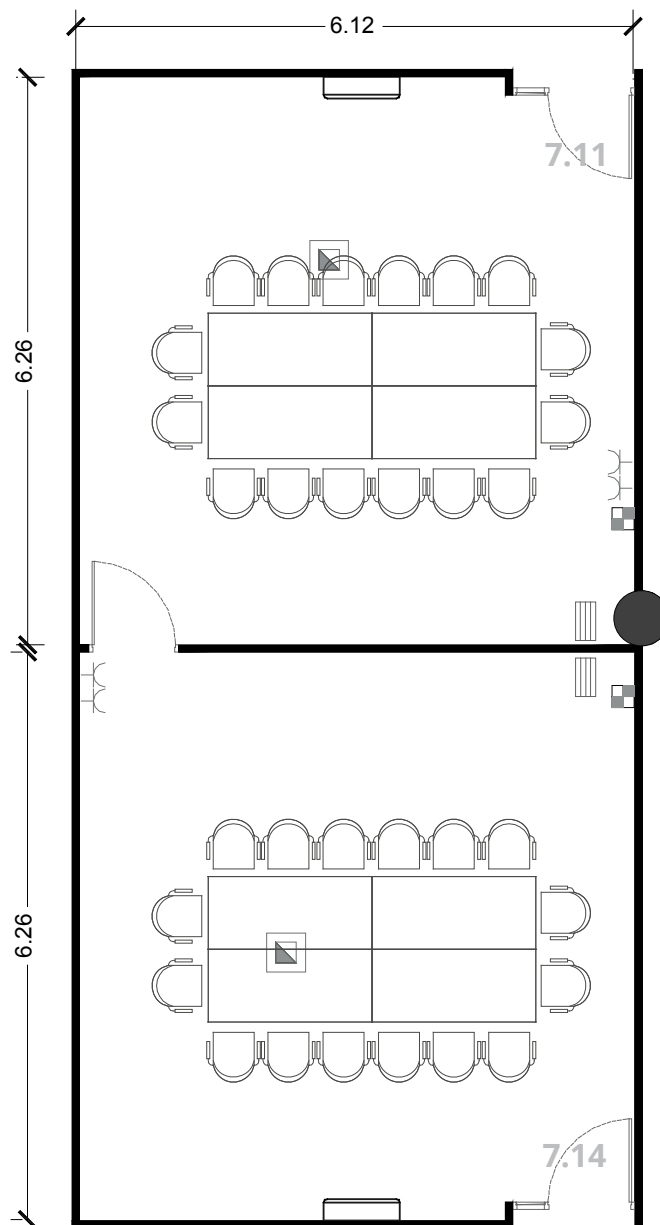



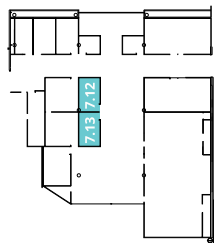

## Room 7.12 and 7.13



24 sqm each

Room height: 3.00 m

Capacity: 14 pax each

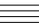
-  Built-in floor box
-  4 X wall sockets
-  Power socket
-  Air conditioning unit
-  Ventilation grill

Room capacity: 14 pax each

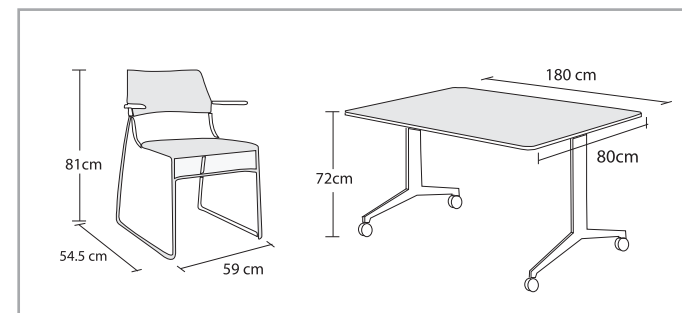
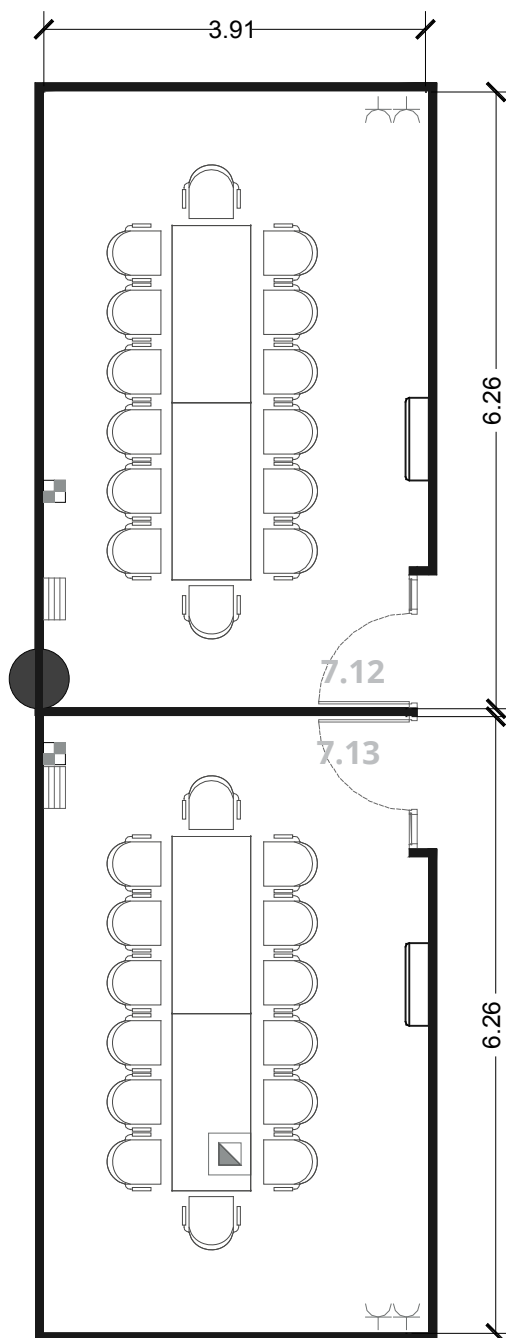





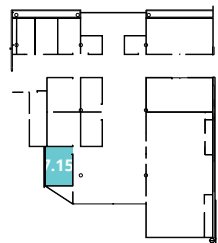

# Room 7.15

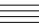

35 sqm  
Room height: 3.00 m

-  Built-in floor box
-  4 X wall sockets
-  Power socket
-  Air conditioning unit
-  Ventilation grill

Room capacity: 16 pax

