







# Room 7.1 A, B, C



253 sqm (81 + 91 + 81sqm)  
Room height: 4.47 m

Soundproof doors and walls  
The room can be divided with airwalls

-  Emergency exit
-  Fire extinguisher
-  Built-in floor box
-  4 X wall sockets
-  Power socket
-  Air conditioning unit
-  Ventilation grill

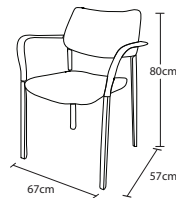

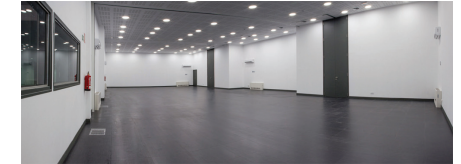
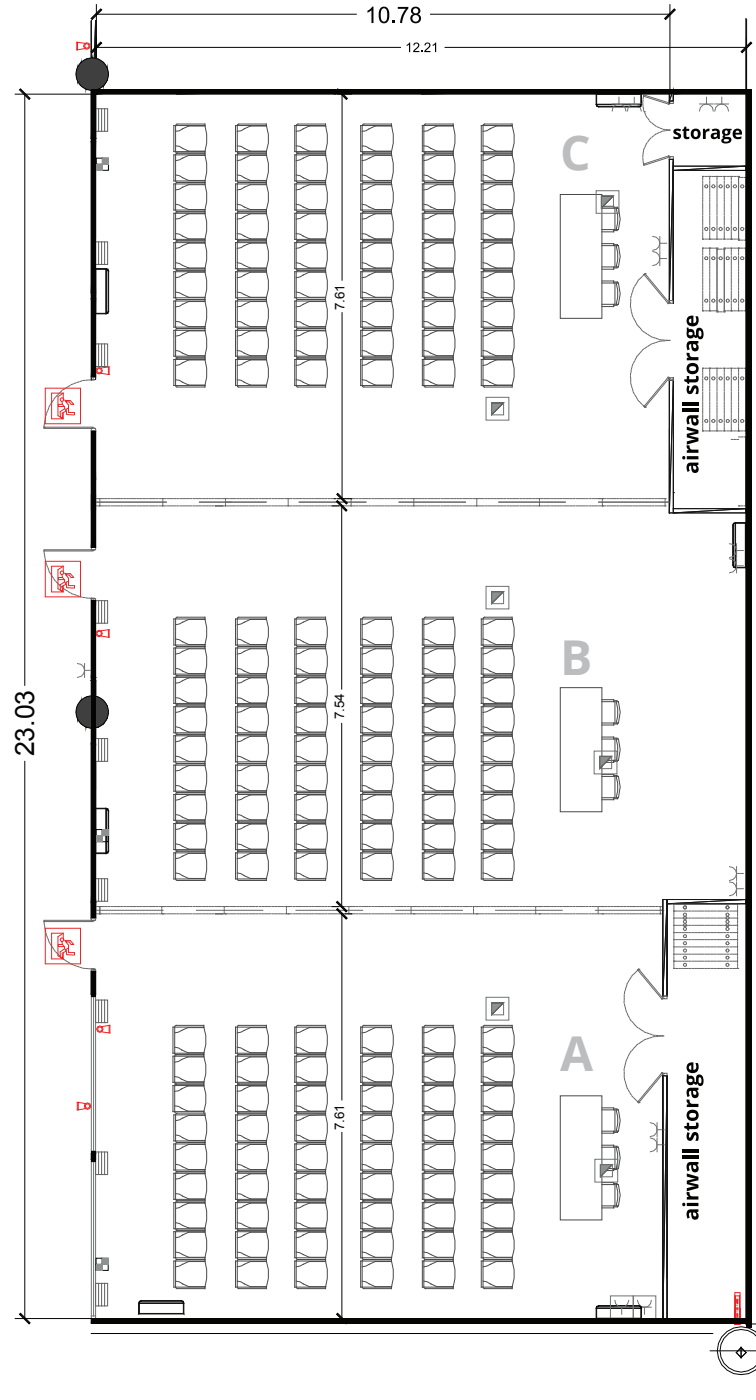
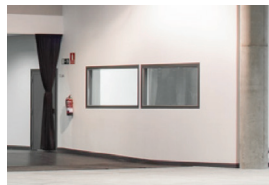

There are two soundproof windows in this room  
Dimensions: 1.92m X 0.88m each

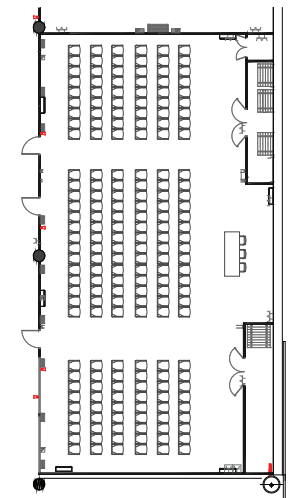

Option with no partitions:

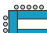
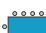

ROOM CAPACITIES				
				
	Theatre	Classroom*	U shape*	Boardroom*
<b>7.1</b>	200	100	54	56
<b>A</b>	54	30	20	24
<b>B</b>	54	40	20	24
<b>C</b>	54	30	20	24

\* using 160 X 80cm tables for 2 pax each