

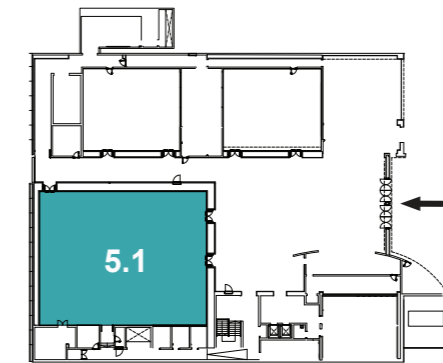

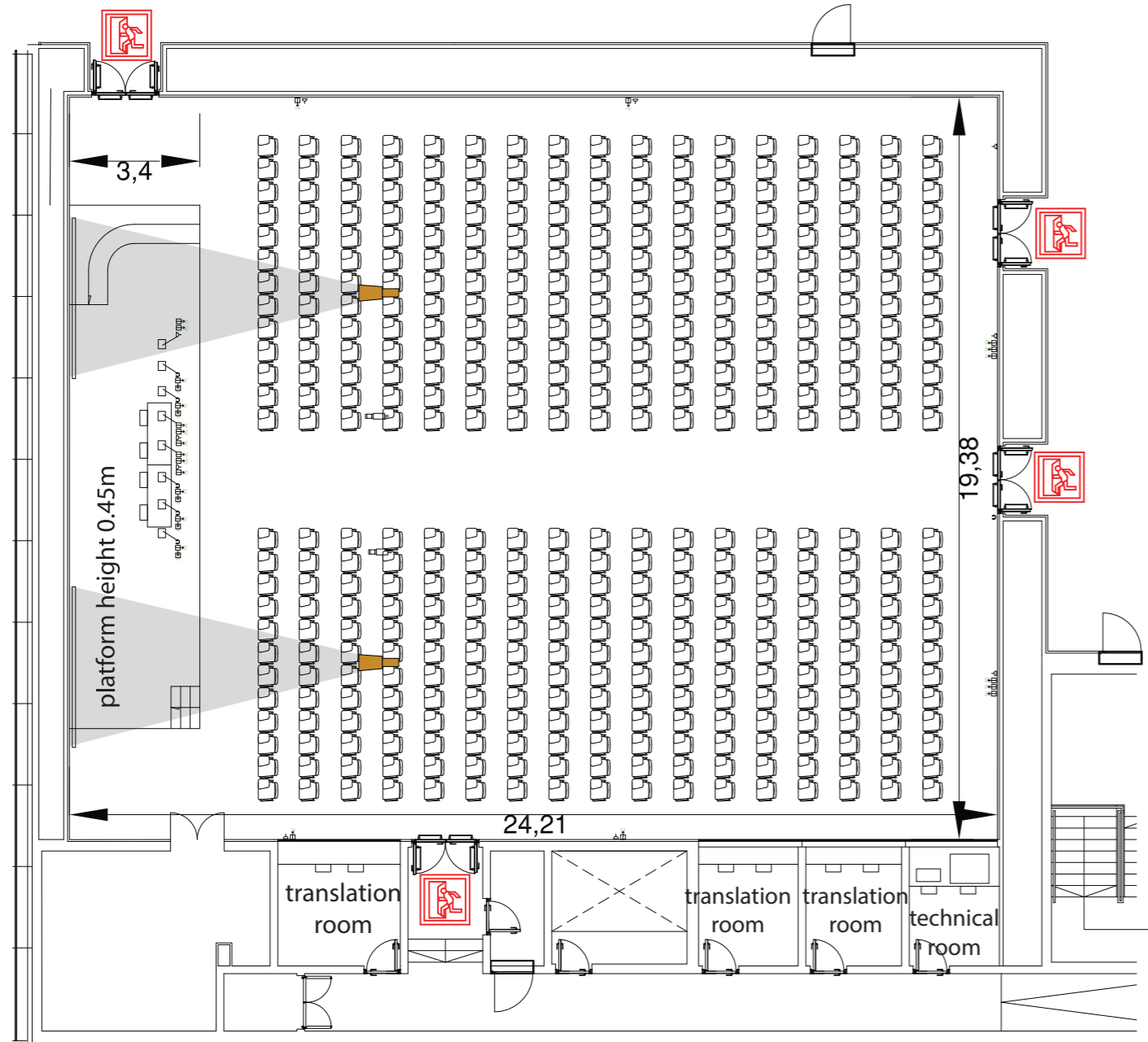







# Conference Center 5 - Room 5.1



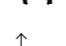
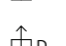

484.20 sqm  
 Room height : 4,80m  
 Screens : 2

-  Emergency exit
-  Fire extinguisher
-  Built-in floor box
-  Video connection
-  Projector
-  Sound connection
-  Telephone line
-  Data/internet line
-  TV/antenna line
-  Power socket

AV installed in the room: PA System, 2 Screens 400x226cm, 2 projectors 6000 lumens HD, HDMI input. 2 fixed cameras, 4 table/lectern mics, 1 wireless mic (handheld/ headset), PC laptop, laser presenter. The AV technician is not included. Contact our team for a quote.

The translation booth does not include transmissor, desk nor receivers.

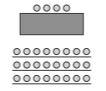
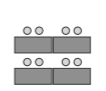
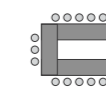
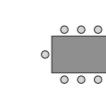
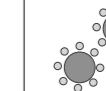
The default layout of the room is theatre style. If you wish to have a different layout, please contact our team (for a quote).

ROOM CAPACITY					
					
Theatre 425	Classroom** 250	U shape 65	Boardroom 100	Banquet -	Cocktail -

\*\*Room furnished with tablet arm chairs.